

## Routers



*The OF 1400 runs remarkably smoothly, thanks to Vibration Stop and innovative design.*

### The New Benchmark

The new OF 1400 Router gives you 2 1/4+ HP in under 10 lbs., takes 1/2", 3/8", 1/4" or 8 mm bits to handle almost any project. It sets the new benchmark for top-quality routers. **NEW RATCHETING SPINDLE.** Change bits in a flash. **NEAR-TOTAL DUST EXTRACTION.** The new chip catcher helps you work super clean when used with a dust extractor. **DEEPER REACH.** Category-beating 2 3/4" routing depth lets you rout countersinks deep into rebates.

The OF 1400 raises the bar in the medium-power router class. It gives you more power in a lighter package, easier operation, smoother running, more routing depth, and the ultimate in dust extraction. With thoroughbred performance and a host of unique features, it takes routing to a new level.

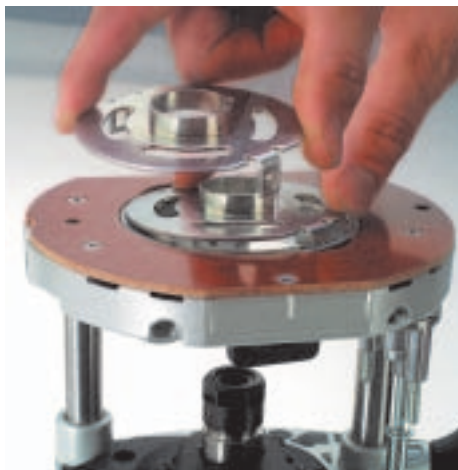

*Toolless copy ring clamping  
Change copy rings fast.*

### OF 1400 EQ benefits at a glance

#### Extremely Versatile Capabilities

- 1400 W, 2 1/4+ HP class.
- 2 3/4" routing depth.
- Double column clamping with a single knob.
- Double guide rod lock with a single knob.
- Patent-pending chip catcher for near total dust extraction.
- Full suite of accessories for all kinds of jobs.
- Takes bits up to 1/2".

#### Convenience and control

- Toolless copy guide bushing clamping.
- Ratcheting spindle – change bits faster than ever before.
- Extremely fast and accurate depth setting, to the nearest 1/256".
- Ergonomic handle.
- Plug-it cord.
- Stepless variable speed and electronic speed control for constant speed under load.
- One-handed operation of controls.

#### Top results, less refinishing

- Smoother, truer running gives top-quality routed surfaces.
- Fiber baseplate prevents marring of surfaces.
- Dust extraction port for cleaner working.

#### Long life

- Extreme durability backed by a 3-year warranty.
- Longlife components and sealed double bearings.
- Electronic overload protection prevents overheating.



*Ratcheting spindle  
A world first. Change bits faster  
than ever before.*



*Near-total dust removal  
A world first. The new chip  
catcher rotates 360° to adjust  
for the way you rout.*

## Routers



*The OF 2000 E is a powerful production-grade router for 1/2" bits.*

### No idle chatter

Many routers work well enough to start with, but after a while they start to run out of round. The result is chatter, vibration, and sub-par results.

This won't happen with the Festool OF 2000 E. This big 3.5 HP class router features sealed double bearings that ensure true running for the life of the tool. The tool runs very smoothly, for better results with less refinishing, and it keeps on running smoothly.

This plus a host of other important benefits make the OF 2000 E the router of choice for demanding professional use. It gets the job done and leaves the chatter to others.



*Smooth going in tough materials.*



*A dust extraction port lets you work clean.*

### OF 2000 E benefits at a glance

#### Heavy-duty capabilities

- 2000 W, 3.5 HP class.
- Highly efficient power transfer to the bit due to low vibration and top-quality materials.
- Full suite of accessories for all kinds of jobs.
- 1/2" collet.

#### Convenience and control

- Extremely fast and accurate depth setting, to the nearest 1/256".
- Ease of use – operate the on/off switch and lock the depth adjustment without taking your hands off the handles.
- Ergonomic angled handles.
- Remarkably low weight in its class.
- Electronic speed control for constant speed under load.

#### Top results, less refinishing

- Smoother, truer running gives top-quality routed surfaces – no chatter or ripples to sand out.
- Fiber baseplate prevents marring of surfaces.
- Dust extraction port for cleaner working.

#### Long life

- Extreme durability backed by 3-year warranty.
- Longlife components and sealed double bearings.
- Electronic overload protection prevents overheating.



*Simple and precise: setting the depth stop.*

### Exact depth

The exact routing depth is almost always critical. You need to be able to adjust the routing depth precisely if you are working to get the results you want. All Festool routers achieve this with a depth stop which is precise to thousandths of an inch. This starts at a zero point you set at the workpiece surface level. No guesswork, no time-consuming calculations, and no going back and refinishing.

## Routers

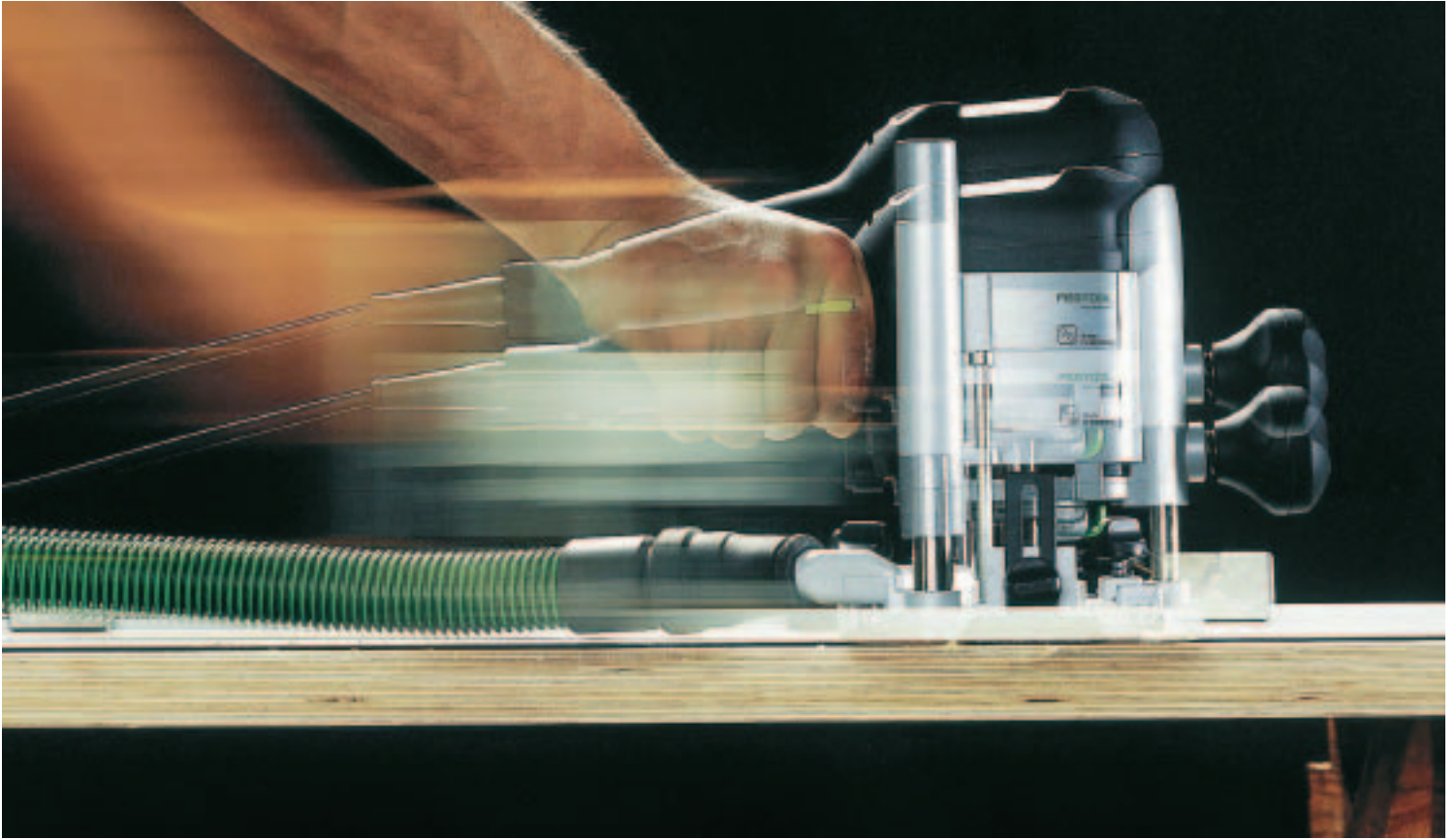

*The OF 1010 EQ is not only extremely versatile, it is also very easy to maneuver.*

### Ease of use

The ergonomics of the OF 1010 EQ give you a host of benefits which add up to an unbeatable tool.

True one-handed operation allows you to switch on, lower the tool, rout, lift the tool and switch it off, all while your other hand is steadying the workpiece. The compact design and the efficient center of gravity make the tool extremely handy. The handles are shaped for easy working from the side or from above. The OF 1010 EQ is also the lightest router of its kind and therefore less tiring to use – a real plus on extended projects.



### OF 1010 EQ benefits at a glance

#### Versatile capabilities

- Wide range of accessories for many applications.
- 1010 W power, takes 8 mm or 1/4" bits
- Fits Festool VS 600 jointing system for fast, precise dovetails.

#### Convenience and control

- Extremely fast and accurate depth setting to the nearest 1/256".
- One-handed operation of controls.
- Simple bit change with spindle stop
- Very light for its class at 6 lbs.
- Electronic speed control maintains constant speed.

#### Top results, less refinishing

- Smooth running for top-quality routs.
- Fiber baseplate prevents marring of surfaces.
- Dust extraction port for cleaner working.

#### Long life

- Extreme durability backed by 3-year warranty.
- Longlife components and sealed bearings.
- Smooth start-up and temperature control protect against overheating.

## Router

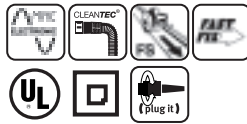

### OF 1010 EQ

Includes:

- 8 mm and 1/4" collets
  - Chip catcher
  - Edge guide
  - Guide stop
  - Guide bushing adaptor
  - In Systainer 3
- Item No. 574 240 .....Price \$325.00  
**See page 5 for package savings.**

## Router

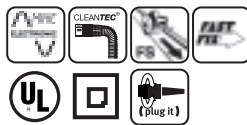

### OF 1400 EQ

Includes:

- 8 mm, 1/2" and 1/4" collets
  - Collet wrench
  - Dust extraction hood
  - Chip catcher
  - Bushing ring adaptor
  - In Systainer 4
- Item No. 574 267 .....Price \$395.00  
**See page 5 for package savings.**

## Router

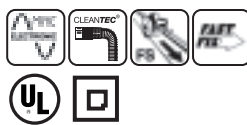

### OF 2000 E

Includes:

- 8 mm and 1/2" collets
  - M12 to 1/2" adapter
  - Dust hood
  - Edge guide
  - Adjustment wrench
  - In Systainer 4
- Item No. 574 216.....\$475.00  
**See page 5 for package savings.**

### OF 2000 Basic\*

As 574 216, except no systainer, 8 mm collet or edge guide  
 Item No. 574 268 .....\$425.00  
**See page 5 for package savings.**

\*Coming in Summer 2006

## OF 1010 EQ

Powerful, high-precision router. A turret stop allows fast and accurate adjustment of the height of the router without the use of special tools. Adjustable speed control produces higher surface quality and longer tool life. The router has a special base runner that leaves no scratches. Designed for one- or two-handed use. Fits Festool

guide rail for precision straight guidance.  
 • Fine depth adjustment accurate to 1/256" (0.1 mm) and "zero" function for quick yet precise depth setting  
 • Turret with three adjustable stops for simple selection of routing depths  
 • Dust extractor port  
 • Edge working accessories available

- Guide rail available as an accessory
- MMC electronics with 5 control and monitoring functions, including soft start, constant speed under load, stepless speed adjustment, temperature and current-triggered overload protection.
- 32 mm Euro-hole drilling attachment available

Power consumption	1010 watts/8.5 amp 120 v AC
Drive shaft speed	10,000 - 23,000 rpm
Quick depth adjustment range	2 3/16" (55 mm)
Fine depth adjustment range	5/16" (8 mm)
Weight	5.94 lbs. (2.7 kg)

(Metric dimensions binding)

## OF 1400 EQ

Powerful, high-precision, 2 1/4 HP class router which weighs under 10 lbs – more power in a lighter package. Unique ratcheting spindle, chip catcher, and double guide column clamping. This versatile 1/2" collet router gives you a level of speed, precision, and all-around performance that's hard to match. Adjustable speed control produces higher surface quality and longer tool life. The router has a special base runner that

leaves no scratches. Fits Festool guide rail for precision straight guidance.  
 • Deep, 2-3/4" category-beating routing depth  
 • Tool-less copy ring clamping allows for fast copy ring changes  
 • Fine depth adjustment accurate to 1/256" (0.1 mm) and "zero" function for quick yet precise depth setting  
 • Double guide rod lock – clamp both guide rods with a single knob

- Dust extractor port and hood
- Edge working accessories available
- Guide rail available as an accessory
- Guide bushing adaptor for use with standard USA bushings
- MMC electronics with 5 control and monitoring functions, including soft start, constant speed under load, stepless speed adjustment, temperature- and current-triggered overload protection.

Power consumption	1400 watts/11.7 amp 120 v AC
Drive shaft speed	10,000 - 22,500 rpm
Quick depth adjustment range	2 3/4" (70 mm)
Fine depth adjustment range	5/16" (8 mm)
Collet dia. range	1/4", 3/8", 1/2" and 8 mm
Weight	9.9 lbs. (4.5 kg)

(Metric dimensions binding)

## OF 2000 E

Tough, 3 1/4 HP class, 1/2" collet production-grade router with double bearings for lasting precision. Fast and precise depth setting, electronic speed control. Very low vibration and ergonomic handle design make even long jobs go easy. Fiber base runner prevents surface marring.

- 2000 Watts - abundant power for any task
- Sealed double bearings for rock-steady true running over the life of the tool
- Precise 1/256" depth setting, extremely accurate plunge action
- Low vibration and ergonomic handle design, for easier use and better results. Light for its class - easy to handle

- Controlled constant speed to suit the workpiece material, even under load
- Electronic starting control keeps startup smooth and jolt-free
- Dust extraction port

Power consumption	2000 watts/16.7 amp 120 v AC
Clamping collet	1/2" (also available: 1/4" dia.)
Rotary Speed	12000-22000 rpm
Fast depth adjustment range	2 9/16" (65 mm)
Fine adjustment range	13/64" (5 mm)
Adjustment accuracy	1/256" (0.1 mm)
Weight	11.2 lbs. (5.1 kg)

(Metric dimensions binding)