

A new dimension in dust extraction



Festool's mobile dust extractors do more than just clean.

Innovative design and versatility are only two of the characteristics of the Festool Cleantec (CT) mobile dust extractors. Offered in three different sizes, the CT units are compact and mobile, with sturdy chassis, extra large wheels, and double casters to easily negotiate obstacles in the shop or on the work site. On sloping ground, the CT 22 and CT 33 can be stabilized with an integrated parking brake.

For added convenience, one or more Systainers can be secured to the top of the unit, or simply use the large flat space as a handy place to lay tools. All will work wet or dry with no complex conversion, and all are remarkably quiet.

Cleantec Mobile Dust Extractors

CT 22 and CT 33 now come standard equipped with HEPA filters. Regular HEPA filtration frees the air of up to 99.97% of all particulate down to .3 microns in size. Developed by the Atomic Energy Commission to remove radioactive dust from industrial exhaust, high efficiency particulate air (HEPA) filters are now the primary filtration systems for the most sensitive manufacturing and healthcare environments. There is no better filtration available on the market today.



With Festool, HEPA filtration improves to 99.99% dust-free.

The benefits at a glance



Easier to use

- Tool-triggered auto-start for convenient use.
- Quieter running for a more pleasant working environment with less distraction.



- On-board storage compartment for an extra bag and accessory items.



- Larger wheels roll easily over most obstacles and give increased stability.

- Parking brake for a stable position.

- Available handle for the CT22 and CT33 improves mobility and ease of handling.



Superior functionality

- Adjustable power for all kinds of jobs.
- Long, flexible, non-kink hose.



- Sys-Dock for latching on a Systainer for easy tool transport and storage.



- Level Stop for wet vacuuming – electronic sensors automatically turn motor off when maximum liquid capacity is reached. No moving parts mean improved reliability and prolonged life.

Better filtration

- Flat filter has a surface area four times greater than regular corrugated filters.



- Integrated flat filter quick cleaning system – cleans the filter with a quick push-pull.
- Interior design makes full use of filter bag capacity.

Mobile dust extractor



CT MINI

Includes:

- 1 fitted filter bag and 1 spare
- 1 antistatic suction hose, 1" x 11.5 ft. (27 mm x 3.5 m)
- Angle adapter
- Delivered in a box

Item No. 583 360Price \$285.00

See page 5 for package savings.

CT MINI

- For non-hazardous dusts
- 2.6 gal (10 L) capacity
- Low weight and small size, so you can work clean anywhere, to save cleanup time and extend the life of tools and consumables
- Tool-triggered or manual start
- Locking brake prevents accidental movement
- Quiet running for a more pleasant working environment
- On-board extra bag storage for fast replacement
- Wet vacuum capability
- Long, flexible, non-kink hose
- Flat top and Sys-Dock for latching on a Systainer for easy tool transport and storage
- Antistatic equipment standard
- Wet and dry extraction with no complicated conversion

Container/Filter bag capacity	2.6 gal/2 gal
Depth x Width x Height	17.5" x 13.5" x 16.5" (440 x 340 x 420 mm)
Weight	21 lbs. (9.5 kg)
Noise (sound level)	72 dB (A)
Power consumption	350 - 1200 watts/3 - 10 amps 120 v AC
Max. suction capacity	99 CFM (2800 l/min)
Max. vacuum	80" static water lift (20000 Pa)

(Metric dimensions binding)

Mobile dust extractor



CT 22 E

Includes:

- HEPA filters
- 1 fitted filter bag
- 1 antistatic suction hose, 1" x 11.5 ft. (27 mm x 3.5 m)
- Delivered in a box

Item No. 583 366Price \$425.00

See page 5 for package savings.

CT 22 E

- For non-hazardous dusts
- 5.8 gal. (22 L) capacity
- Larger wheels provide stability and ease of movement
- Locking brake on rear wheels means no accidental movement of the dust extractor
- Large flat area for tools or Systainer stacking
- Tool-triggered or manual on-off switch with smooth start-up and shut-off delay
- Replaceable filter bag
- Stepless electronic suction control
- Wet and dry extraction with no complicated conversion
- Integrated cleaning device cleans the filter in the blink of an eye
- Blower port
- Standard antistatic equipment protects against electrostatic charging

Container/Filter bag capacity	5.8 gal/5.3 gal
Depth x Width x Height	24" x 15" x 17" (625 x 380 x 440 mm)
Weight	26.5 lbs. (12 kg)
Noise (sound level)	72 dB (A)
Power consumption	350 - 1200 watts/3 - 10 amps 120 v AC
Max. suction capacity	134 CFM (3800 l/min)
Max. vacuum	90" static water lift (23000 Pa)

(Metric dimensions binding)

Mobile dust extractor



CT 33 E

Includes:

- HEPA filters
- 1 fitted filter bag
- 1 antistatic suction hose, 1" x 11.5 ft. (27 mm x 3.5 m)
- Delivered in a box

Item No. 583 368Price \$490.00

See page 5 for package savings.

CT 33 E

- For non-hazardous dusts
- 8.7 gal. (33 L) capacity
- Larger wheels provide stability and ease of movement
- Locking brake on rear wheels means no accidental movement of the dust extractor
- Large flat area for tools or Systainer stacking
- Tool triggered or manual on-off switch with smooth start-up and shut-off delay
- Replaceable filter bag
- Stepless electronic suction control
- Integrated storage compartment
- Wet and dry extraction with no complicated conversion
- Integrated cleaning device cleans the filter in the blink of an eye
- Blower port
- Standard antistatic equipment protects against electrostatic charging

Container/Filter bag capacity	8.7 gal/7.9 gal
Depth x Width x Height	24" x 15" x 22" (625 x 380 x 550 mm)
Weight	32 lbs. (14.5 kg)
Noise (sound level)	72 dB (A)
Power consumption	350 - 1200 watts/3 - 10 amps 120 v AC
Max. suction capacity	134 CFM (3800 l/min)
Max. vacuum	90" static water lift (23000 Pa)

(Metric dimensions binding)

Cleaning sets

The right set for every application

Cleaning sets

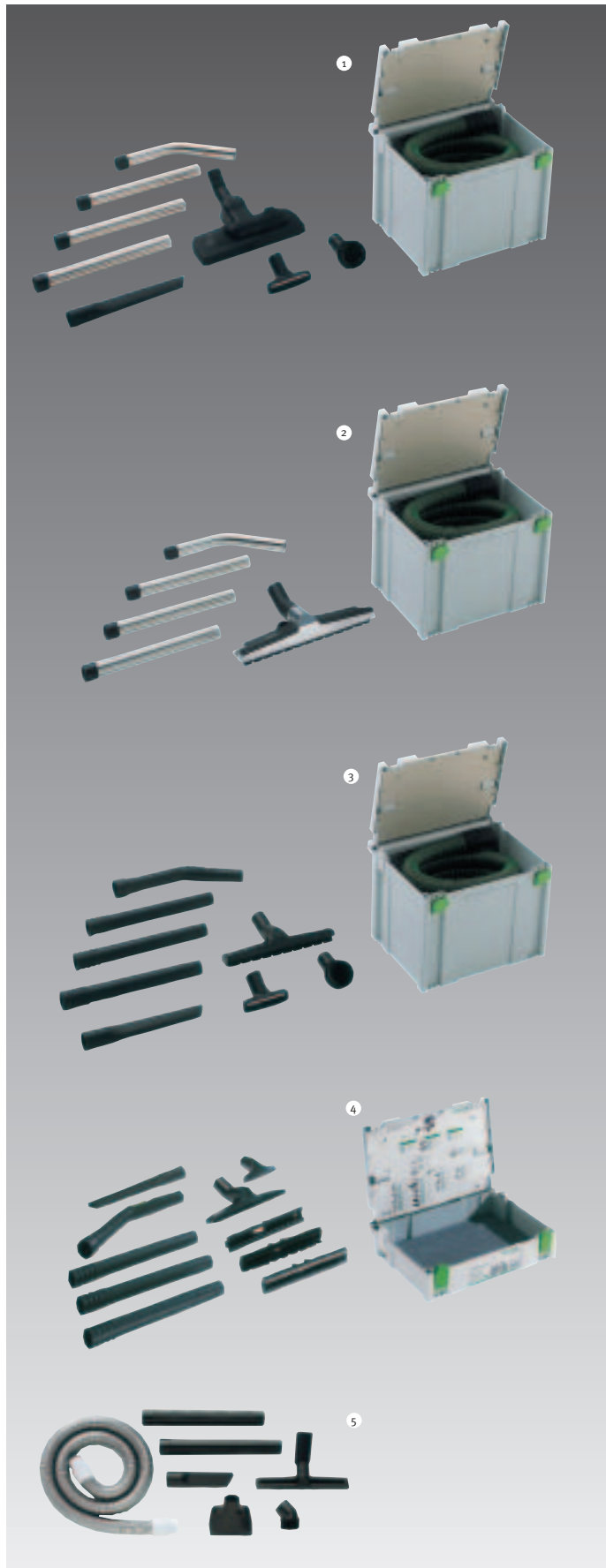

No.	Description	Type	Item No.	Price
1	Installer cleaning set in Systainer SYS 4 with deep drawn insert SYS TZE-RS suction hose D 36 x 11.5' (3.5 m) AS curved hand tube D 36 HR-M extension tube D 36 VR-M 3x carpet nozzle D 36 TD crevice nozzle D 36 FD upholstery nozzle D 36 PD suction hose D 36 SP	D 36 HW-RS	454 766	177.00
2	Workshop cleaning set in Systainer SYS 4 with deep drawn insert SYS TZE-RS suction hose D 36 x 11.5' (3.5 m) AS curved hand tube D 36 HR-M extension tube D 36 VR-M 3 x floor nozzle D 36 BD -370	D 36 WB-RS	454 767	203.00
3	Universal cleaning set in Systainer SYS 4 with deep drawn insert SYS TZE-RS suction hose D 36 x 11.5' (3.5 m) curved hand tube D 36 HR-K extension tube D 36 VR-K 3 x floor nozzle D 36 BD 300 crevice nozzle D 36 FD upholstery nozzle D 36 PD suction brush D 36 SP	D 36 DIY-RS	454 769	121.00
4	Compact cleaning set in Systainer SYS 1 extension tube, plastic D 36 VR-K 3x floor nozzle, 4 part D 36 BD 270 upholstery nozzle D 36 PD hand pipe, bent, plastic D 36 HR-K crevice nozzle D 36 FD (suction hose not included)	D27/D36 K-RS	456 736	62.00
5	Industrial cleaning set in cardboard box suction hose D 50 x 8.25' (2.5 m) extension tube D 50 VR-K 2 x floor nozzle D 50 BD 370 square nozzle D 50 QD suction brush D 50 SP crevice nozzle D 50 FD	D 50 GS-RS	454 770	88.50

Accessories for dust extractors

Suction hoses



No.	Description and application	Anti-static ^{a)}	Type	Item No.	Price
1	Suction hoses Temperature resistant to 70°C (158°F), leakage resistance of antistatic version ^{b)} ≤ 10 ⁶ Ohm. Temperature resistant to 70° C (158°F) with rotating adapter and reducing sleeve (1" x 11.5') with rotating adapter and reducing sleeve (1" x 16.5') with rotating adapter and reducing sleeve (1 7/16" x 11.5') with rotating adapter and reducing sleeve (1 7/16" x 16.5') with rotating adapter and reducing sleeve (1 7/16" x 23') with rotating adapter and reducing sleeve (2" x 8.25') with rotating adapter and reducing sleeve (2" x 13') with rotating adapter and reducing sleeve (1" x 11.5') with rotating adapter and reducing sleeve (1" x 16.5') with rotating adapter and reducing sleeve (1 7/16" x 11.5') with rotating adapter and reducing sleeve (1 7/16" x 16.5') with rotating adapter and reducing sleeve (1 7/16" x 23') with rotating adapter and reducing sleeve (2" x 8.25') with rotating adapter and reducing sleeve (2" x 13')		<ul style="list-style-type: none"> • D 27 x 3.5 m-AS • D 27 x 5 m-AS • D 36 x 3.5 m-AS • D 36 x 5 m-AS • D 36 x 7 m-AS • D 50 x 2.5 m-AS • D 50 x 4 m-AS 	452 878 452 880 452 882 452 884 452 886 452 888 452 890	76.50 103.00 105.00 124.00 157.00 89.50 124.00
			D 27 x 3.5 m D 27 x 5 m D 36 x 3.5 m D 36 x 5 m D 36 x 7 m D 50 x 2.5 m D 50 x 4 m	452 877 452 879 452 881 452 883 452 885 452 887 452 889	49.50 56.50 62.00 76.50 89.50 56.50 78.00

^{b)} Antistatic versions are only effective when used with an AS dust extractor.

Hose sleeves

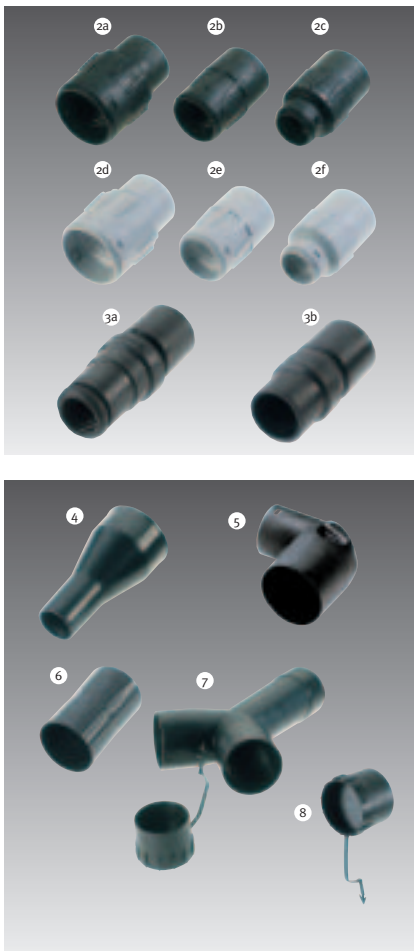

No.	Description and application	Anti-static ^{a)}	Type	Item No.	Price
2	Rotating adapters hose connector to fit inlet nozzle of dust extractor, external dia. 2 9/32" (58 mm) 2a Antistatic version for D 50 suction hose 2b Antistatic version for D 36 suction hose 2c Antistatic version for D 27 suction hose 2d For D 50 suction hose 2e For D 36 suction hose 2f For D 27 suction hose		<ul style="list-style-type: none"> • D 50 DAG-AS • D 36 DAG-AS • D 27 DAG-AS 	452 896 452 894 452 892	18.50 16.00 13.00
3	Reducing sleeve hose connector for electric tool or suction nozzle 3a with rotating adapter for D 27 suction hose 3b antistatic version with rotating adapter for D 36 suction hose		<ul style="list-style-type: none"> • D 50 DAG • D 36 DAG • D 27 DAG 	452 895 452 893 452 891	16.00 13.00 11.00
4	Suction adapter for reducing from D50 to D36 hose		D 50/D 36	452 897	9.50
5	Angle adapter for CT MINI		<ul style="list-style-type: none"> • D 27/DAG/90-AS 	456 806	18.00
6	Connector sleeve³⁾ (antistatic) with corresponding rotating adapter to connect suction hoses D 50/D 36/D 27		D 50/36/27-CT	493 047	11.00
7	Y-piece with blanking plug⁴⁾ to connect two suction hoses D 27/D 36/D 50		<ul style="list-style-type: none"> • D 50 SV-AS/D 50V 	452 898	24.00
8	Blanking plug for retrofitting on CT 11/22/33, to seal off inlet during transportation.		D 50 V	452 899	7.50

³⁾ Antistatic versions are only effective when used with an AS dust extractor.

⁴⁾ For simultaneous connection of two electric tools with dust extraction.

³⁾ With D 36/D 27 hoses the reducing sleeve for the hose must be replaced by a D 36/D 27 rotating adapter.

Accessories for dust extractors

Tubes

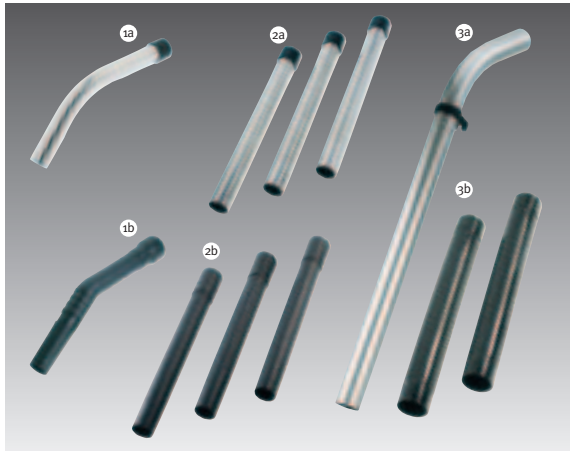

No.	Description and application	Type	Item No.	Price
1a	Curved hand tube Stainless steel	D 36 HR-M	452 900	35.50
1b	Curved hand tube Polypropylene (PP) with air regulating slide to adjust suction power	D 36 HR-K	452 901	13.00
2a	Extension tube Stainless steel, 3 piece, 37 1/2" (950 mm)	D 36 VR-M 3 x	452 902	40.00
2b	Polypropylene (PP), 3 piece, 37 1/2" (L= 950 mm)	D 36 VR-K 3 x	452 903	16.00
3a	One-piece anodized aluminum, 43 1/2" (L= 1100 mm)	D 50 VR-M	447 599	100.00
3b	Plastic, 2-piece, 38" (L= 970 mm)	D 50 VR-K 2 x	440 412	24.00

Floor nozzles



No.	Description and application	Type	Item No.	Price
4a	Floor nozzle high quality industrial design, aluminum, width 14 5/8" (370 mm), 2 casters, 2 brush inserts	D 36 BD 370	452 908	95.00
4b	Replaceable wearing parts: brush insert, casters		452 934	16.00
4c	Retrofit kit: water extraction: rubber lips and casters		452 936	17.00
4d	Floor nozzle high quality industrial design, aluminum, width 17 11/16" (450 mm), 2 casters, 2 brush inserts	D 50 BD 450	452 910	108.00
4e	Replaceable wearing parts: brush insert, casters		452 935	19.00
4f	Retrofit kit: water extraction: rubber lips and casters		452 937	21.00
5a	Floor nozzle plastic, width 11 13/16" (300 mm) 2 casters, 2 brush inserts	D 36 BD 300	452 907	25.00
5b	Floor nozzle , plastic, width 14 5/8" (370 mm), 2 casters, 2 brush inserts	D 50 BD 370	452 909	41.00
6	Floor nozzle, 4-piece, plastic, with 3 replaceable inserts (brushes, rubber lips, carpet)	D 36 BD 270	452 906	21.50
7	Carpet nozzle , with sliding base for changeover from carpet to smooth floor	D 36 TD	452 911	38.00
8	Turbo combination suction brush for textile and linoleum floors with 4 casters, width 10 5/8" (270 mm), brush rollers driven by intake air, requires 36 mm hose	D 36 TKB	450 644	83.00

Special nozzles/brushes

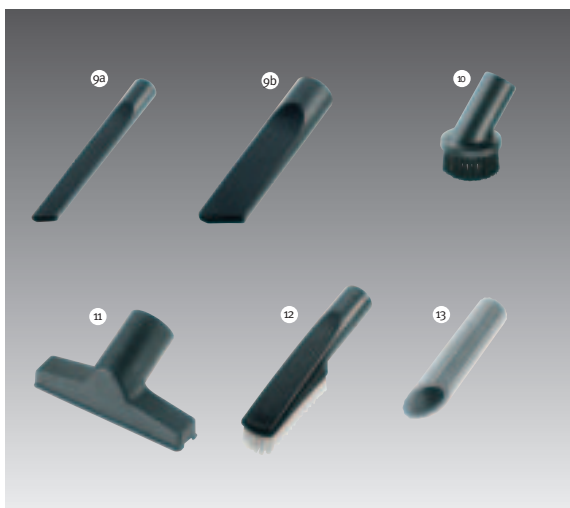

No.	Description and application	Type	Item No.	Price
9a	Crevice nozzle Plastic length 14 5/8" (370 mm)	D 36 FD	452 904	5.50
9b	Crevice nozzle Plastic length 14 5/8" (370 mm)	D 50 FD	452 912	13.00
10	Suction brush Plastic, dia. 2 13/16" (70 mm)	D 36 SP	440 404	8.50
11	Upholstery brush Plastic, with brush insert width 4 11/16" (120 mm)	D 36 PD	440 406	6.50
12	Universal brush nozzle Plastic, brush ring 4 11/16" x 1 5/8" (120 x 40 mm)	D 36 UBD	440 403	10.50
13	Bevel ended nozzle Rubber, length 7 1/2" (190 mm), outside dia. 1 5/8" (40 mm)	D 36 SRD	411 810	19.00

Accessories for dust extractors

Other accessories



No.	Description	CT	CT	CT	CT	Type	Item No.	Price
		MINI	11E	22E	33E			
1	Spark trap For use when sanding materials which generate sparks			●	●	D 50 FL	484 733	94.00
2	Handle			●	●	SB-CT	452 921	62.00
3	Hose hook		●	●	●	SH-CT	452 998	27.50
4	Suction hose holder Eliminates the tripping hazard of hoses on the floor		●	●	●	SH-CT/SR	487 072	28.50
5	Dirt trap Collects wet coarse dirt			●	●	SBH-CT 22 SBH-CT 33	452 925 452 926	82.00 95.50
6	CT adapter plug replacement (not shown)	●	●	●	●		493 232	8.00
7	Boom arm Keeps cord and hose out of the way (must use with handle above)			●	●		492 753	159.00

CT filters and filter bags

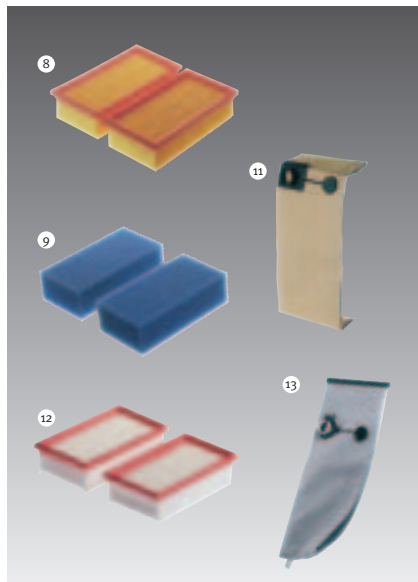

No.	Description	CT	CT	CT	CT	Type	Item No.	Price
		MINI	11E	22E	33E			
8	Filter element Main filter, 2 pieces 1 piece	●	●	●	●	HF-CT HF-CT	452 923 456 790	25.00 13.00
9	Wet Filter element Wet filter, 2 pieces 1 piece	●	●	●	●	NF-CT NF-CT	452 924 456 805	11.50 12.50
10	Longlife filter element Main filter, 2 pieces (not shown)		●	●	●	HF-CT	454 869	50.50
11	Filter bag 5 pieces	●	●	●	●	FIS-CT MINI FIS-CT 11 FIS-CT 22 FIS-CT 33	456 772 452 974 452 970 452 971	16.00 24.00 26.00 29.00
12	HEPA filter element		●	●	●		493 334	52.00
13	Longlife filter bag re-usable bag			●	●	FIS-CT 22 FIS-CT 33	456 737 456 738	177.00 184.00

SR-filters

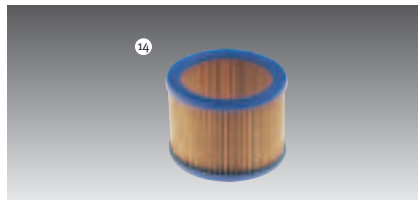

No.	Description	SR 201	Item No.	Price
14	Absolute Filters, BIA-approved	●	AB-FI/U (3150)	485 808 31.50
15	Filter bag, SR series vacuums 5 pieces 20 pieces (not shown)	● ●	FIS-SR 200 FIS-SR 200	487 070 487 874 47.50 113.00

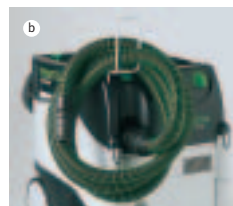

- a) Suction hose holder mounted on CT mobile extractor, hose extended
- b) Suction hose holder mounted on CT mobile extractor, hose coiled